

5. REPORT

Background

5.1 An application for a Premises Licence Variation, by Roseflame Limited in respect of Kassaba, 1 New River Avenue, Hornsey, London N8 7QD under the Licensing Act 2003.

5.2 Details of the application being sought under the Premises Licence Variation
APP1

To replace existing conditions under the Operating Schedule with the conditions contained in Section P of the application form.

To add further facilities for Regulated Entertainment and to extend hours for licensable activity as below:

Provision of Regulated Entertainment: Films, Live Music, Recorded Music, Performances of Dance, Anything of a Similar Description to That of Live or Recorded Music or Performances of Dance, Provision of Facilities for Making Music, Provision of Facilities for Dancing, Provision of Facilities of a Similar Description to that of making music or dancing

Sunday to Thursday	1100 to 0200
Friday & Saturday	1100 to 0300

Provision of Late Night Refreshment

Sunday to Thursday	2300 to 0200
Friday & Saturday	2300 to 0300

Supply of Alcohol

Sunday to Thursday	1100 to 0130
Friday & Saturday	1100 to 0230

An additional hour to the standard and non-standard times on the day when British Summertime commences.

New Years Eve: From the end of permitted hours on New Years Eve to the start of permitted hours on New Years Day

One additional hour on the following dates: Christmas Eve, Boxing Day, St George's Day, St Patrick's Day, Valentine's Day, Mothering Sunday & Fathers Day

Opening Hours:

Sunday to Thursday	1100 to 0200
Friday & Saturday	1100 to 0300

An additional hour to the standard and non-standard times on the day when British Summertime commences.

New Years Eve: From the end of permitted hours on New Years Eve to the start of permitted hours on New Years Day

One additional hour on the following dates: Christmas Eve, Boxing Day, St George's Day, St Patrick's Day, Valentine's Day, Mothering Sunday & Fathers Day

General-all four licensing objectives

5.3 Crime and Disorder

All staff shall be trained in licensing law and this will include the law in relation to children and alcohol and the procedures that shall be adopted if it is considered that an individual may be under the age of 18. A record of the staff training will be maintained and can be inspected by the Police or Licensing Authority.

A proof of age scheme, such as Challenge 21, shall be operated at the premises where the only acceptable forms of identification will be recognised photographic identification cards, such as driving licence or passport.

Suitable beverages other than intoxicating liquor, including drinking water, shall be available at the premises.

The premises shall install and maintain a comprehensive CCTV system as per the minimum requirements of the Metropolitan Police Crime Prevention Officer. All entry and exit points will be covered, enabling frontal identification of every person entering in any light condition. The CCTV system shall continually record whilst the premises is open for licensable activities and during all times when customers remain on the premises. All recordings shall be stored for a minimum period of 31 days with date and time stamping. Records shall be made immediately available upon the request of police or authorised officers throughout the proceeding 31 day period.

A staff member from the premises who is conversant with the operation of the CCTV shall be on the premises at all times when the premises are open to the public. This staff member shall be able to show police recent data or footage with the absolute minimum of delay when requested.

The premises will operate a zero tolerance towards drugs.

5.4 Public Safety

The premises will comply with all existing legislation in relation to fire safety, health and safety and food hygiene.

5.5 Public Nuisance

The premises licence holder shall use reasonable endeavours to ensure that no customer carrying open or sealed bottles shall be admitted to the premises (including any external seating area) at any time that the premises are open to the public.

The premises licence holder shall use reasonable endeavours to ensure that no persons shall be allowed to leave the licensed premises (including any external seating area) whilst in the possession of any drinking vessel or open glass bottle, whether empty or containing any beverage. .

Prominent clear notices shall be displayed at all exits requesting that customers request the needs of local residents and leave the premises and area quietly.

When regulated entertainment (excluding films and plays) are provided all externally opening doors and windows must not be fixed open. In the event that the doors or windows are fixed open, the regulated entertainment must cease.

The premises licence holder shall ensure that the disposal of glass and bottles into outside bins does not take place between the hours of 23:00hrs and 07:00hrs.

The premises will risk assess the requirement for door supervisors.

Noise or vibration must not emanate from the premises so as to cause a nuisance to nearby properties.

Staff training will continue and include training in relation to accidents to staff and customers on the premises and the requirement to deal with such problems.

The premises will operate a dispersal policy, a copy of which will be made available to the Police and Local Authority Licensing Officers as required.

5.6 Child Protection

6. RELEVANT REPRESENTATIONS (CONSULTATION)

Responsible authorities:

6.1 Comments of Metropolitan Police

Have no objections to this application.

6.2 Comments of Enforcement Services:

Noise Team –APP 2

Have made representation.

Food Team

Have no objections to this application.

Health and Safety

Have no objections to this application

Trading Standards

Have no objections to this application

6.3 Fire Officer

Have no objections to this application

6.4 Planning Officer

Have no objections to this application

6.5 Comments of Child Protection Agency or Nominee

No representation made on this matter

7.0 Interested Parties – App 3

3 letters of representation have been received against this application.

8.0 Financial Comments

The fee which would be applicable for this application was **£315.00**.

APPENDIX 1-APPLICATION

London Borough of Haringey

Application to vary a premises licence under the Licensing Act 2003

PLEASE READ THE FOLLOWING INSTRUCTIONS FIRST

Before completing this form please read the guidance notes at the end of the form. If you are completing this form by hand please write legibly in block capitals. In all cases ensure that your answers are inside the boxes and written in black ink. Use additional sheets if necessary.

You may wish to keep a copy of the completed form for your records.

We Roseflame Limited

(Insert name(s) of applicant)

being the premises licence holder, apply to vary a premises licence under section 34 of the Licensing Act 2003 for the premises described in Part 1 below

Premises licence number LN00002603
--

Part 1 – Premises Details

Postal address of premises or, if none, ordnance survey map reference or description			
Kassaba 1 New River Avenue Hornset			
Post town	London	Post code	N8 7QD

Telephone number at premises (if any)	
Non-domestic rateable value of premises	£0.00

Part 2 – Applicant details

Daytime contact telephone number			
E-mail address (optional)			
Current postal address if different from premises address	Cambridge House 27 Cambridge Park		
Post Town	Wanstead	Postcode	E11 2PU

Part 3 - Variation

Please tick yes

Do you want the proposed variation to have effect as soon as possible?

If not do you want the variation to take effect from

Day	Month	Year
<input type="text"/>	<input type="text"/>	<input type="text"/>

Please describe briefly the nature of the proposed variation (Please see guidance note

1. To extend the hours for supply of alcohol Sundays to Thursday until 01:30 hours and Friday & Saturday until 02:30 hours
2. To extend the hours for all regulated entertainment, late night refreshment and closing Sundays to Thursdays until 02:00 hours and Friday & Saturday until 03:00
3. To add further facilities for regulated entertainment 11:00 to 02:00 hours Sundays to Thursdays and 11:00 to 03:00 Fridays & Saturdays
4. To replace the existing conditions under the Operating Schedule

If your proposed variation would mean that 5,000 or more people are expected to attend the premises at any one time, please state the number expected to attend

N/A

Part 4 Operating Schedule

Please complete those parts of the Operating Schedule below which would be subject to change if this application to vary is successful.

Provision of regulated entertainment

Please tick yes

- a) plays (if ticking yes, fill in box A)
- b) films (if ticking yes, fill in box B)
- c) indoor sporting events (if ticking yes, fill in box C)
- d) boxing or wrestling entertainment (if ticking yes, fill in box D)
- e) live music (if ticking yes, fill in box E)
- f) recorded music (if ticking yes, fill in box F)
- g) performances of dance (if ticking yes, fill in box G)
- h) anything of a similar description to that falling within (e), (f) or (g) (if ticking yes, fill in box H)

Provision of entertainment facilities:

- i) making music (if ticking yes, fill in box I)
- j) dancing (if ticking yes, fill in box J)
- k) entertainment of a similar description to that falling within (i) or (j) (if ticking yes, fill in box K)

Provision of late night refreshment (if ticking yes, fill in box L)

Sale by retail of alcohol (if ticking yes, fill in box M)

In all cases complete boxes N, O and P

A

Plays Standard days and timings (please read guidance note 6)			Will the performance of a play take place indoors or outdoors or both – please tick (please read guidance note 2)	Indoors	<input type="checkbox"/>
				Outdoors	<input type="checkbox"/>
Day	Start	Finish		Both	<input type="checkbox"/>
Mon			Please give further details here (please read guidance note 3)		
Tue					
Wed			State any seasonal variations for performing plays (please read guidance note 4)		
Thur					
Fri			Non standard timings. Where you intend to use the premises for the performance of plays at different times to those listed in the column on the left, please list (please read guidance note 5)		
Sat					
Sun					

B

Films Standard days and timings (please read guidance note 6)			Will the exhibition of films take place indoors or outdoors or both – please tick (please read guidance note 2)	Indoors	<input checked="" type="checkbox"/>
				Outdoors	<input type="checkbox"/>
Day	Start	Finish		Both	<input type="checkbox"/>
Mon	11:00	02:00	Please give further details here (please read guidance note 3) Amplified music video, sport, entertainment programs and any entertainment of a like kind (nothing of an adult nature)		
Tue	11:00	02:00			
Wed	11:00	02:00	State any seasonal variations for the exhibition of films (please read guidance note 4)		
Thur	11:00	02:00			
Fri	11:00	03:00	Non standard timings. Where you intend to use the premises for the exhibition of films at different times to those listed in the column on the left, please list (please read guidance note 5) An additional hour to the standard and non-standard times on the day when British Summertime commences New Years Eve – from the end of permitted hours on New Years Eve to the start of permitted hours on New Years Day One additional hour on the following dates: Christmas Eve, Boxing Day, St Georges Day, St Patricks Day, Valentines Day, Mothering Sunday & Fathers Day		
Sat	11:00	03:00			
Sun	11:00	02:00			

C

Indoor sporting events Standard days and timings (please read guidance note 6)			<u>Please give further details</u> (please read guidance note 3)
Day	Start	Finish	
Mon			<u>State any seasonal variations for indoor sporting events</u> (please read guidance note 4)
Tue			
Wed			
Thur			<u>Non standard timings. Where you intend to use the premises for indoor sporting events at different times to those listed in the column on the left, please list</u> (please read guidance note 5)
Fri			
Sat			
Sun			

D

Boxing or wrestling entertainments Standard days and timings (please read guidance note 6)			<u>Will the boxing or wrestling entertainment take place indoors or outdoors or both – please tick</u> (please read guidance note 2)	Indoors	<input type="checkbox"/>
Day	Start	Finish		Outdoors	<input type="checkbox"/>
Mon			<u>Please give further details here</u> (please read guidance note 3)	Both	<input type="checkbox"/>
Tue					
Wed					
Thur			<u>State any seasonal variations for boxing or wrestling entertainment</u> (please read guidance note 4)		
Fri					
Sat					
Sun					
			<u>Non standard timings. Where you intend to use the premises for boxing or wrestling entertainment at different times to those listed in the column on the left, please list</u> (please read guidance note 5)		

E

Live music Standard days and timings (please read guidance note 6)			Will the performance of live music take place indoors or outdoors or both – please tick (please read guidance note 2)	Indoors	<input checked="" type="checkbox"/>
				Outdoors	<input type="checkbox"/>
				Both	<input type="checkbox"/>
Day	Start	Finish	Please give further details here (please read guidance note 3) Music may be via artists singing, karaoke, DJ and other of a similar nature		
Mon	11:00	02:00			
Tue	11:00	02:00	State any seasonal variations for the performance of live music (please read guidance note 4)		
Wed	11:00	02:00			
Thur	11:00	02:00	Non standard timings. Where you intend to use the premises for the performance of live music at different times to those listed in the column on the left, please list (please read guidance note 5) An additional hour to the standard and non-standard times on the day when British Summertime commences		
Fri	11:00	03:00			
Sat	11:00	03:00	New Years Eve – from the end of permitted hours on New Years Eve to the start of permitted hours on New Years Day		
Sun	11:00	02:00			
			One additional hour on the following dates: Christmas Eve, Boxing Day, St Georges Day, St Patricks Day, Valentines Day, Mothering Sunday & Fathers Day		

F

Recorded music Standard days and timings (please read guidance note 6)			Will the playing of recorded music take place indoors or outdoors or both – please tick (please read guidance note 2)	Indoors	<input checked="" type="checkbox"/>
Day	Start	Finish		Outdoors	<input type="checkbox"/>
Mon	11:00	02:00	Please give further details here (please read guidance note 3) Amplified music played through an in house sound system	Both	<input type="checkbox"/>
Tue	11:00	02:00			
Wed	11:00	02:00	State any seasonal variations for the playing of recorded music (please read guidance note 4)		
Thur	11:00	02:00			
Fri	11:00	03:00	Non standard timings. Where you intend to use the premises for the playing of recorded music at different times to those listed in the column on the left, please list (please read guidance note 5) An additional hour to the standard and non-standard times on the day when British Summertime commences New Years Eve – from the end of permitted hours on New Years Eve to the start of permitted hours on New Years Day. One additional hour on the following dates: Christmas Eve, Boxing Day, St Georges Day, St Patricks Day, Valentines Day, Mothering Sunday & Fathers Day		
Sat	11:00	03:00			
Sun	11:00	02:00			

G

Performances of dance Standard days and timings (please read guidance note 6)			Will the performance of dance take place indoors or outdoors or both – please tick (please read guidance note 2)	Indoors	<input checked="" type="checkbox"/>
Day	Start	Finish		Outdoors	<input type="checkbox"/>
				Both	<input type="checkbox"/>
Mon	11:00	02:00	Please give further details here (please read guidance note 3) Dancing by staff throughout the premises		
Tue	11:00	02:00			
Wed	11:00	02:00	State any seasonal variations for the performance of dance (please read guidance note 4)		
Thur	11:00	02:00			
Fri	11:00	03:00	Non standard timings. Where you intend to use the premises for the performance of dance at different times to those listed in the column on the left, please list (please read guidance note 5) An additional hour to the standard and non-standard times on the day when British Summertime commences New Years Eve – from the end of permitted hours on New Years Eve to the start of permitted hours on New Years Day One additional hour on the following dates: Christmas Eve, Boxing Day, St Georges Day, St Patricks Day, Valentines Day, Mothering Sunday & Fathers Day		
Sat	11:00	03:00			
Sun	11:00	02:00			

H

Anything of a similar description to that falling within (e), (f) or (g) Standard days and timings (please read guidance note 6)			<u>Please give a description of the type of entertainment you will be providing</u>		
Day	Start	Finish	<u>Will this entertainment take place indoors or outdoors or both – please tick</u> (please read guidance note 2)	Indoors	<input checked="" type="checkbox"/>
Mon	11:00	02:00		Outdoors	<input type="checkbox"/>
			Both	<input type="checkbox"/>	
Tue	11:00	02:00	<u>Please give further details here</u> (please read guidance note 3)		
Wed	11:00	02:00			
Thur	11:00	02:00	<u>State any seasonal variations for entertainment of a similar description to that falling within (e), (f) or (g)</u> (please read guidance note 4)		
Fri	11:00	03:00			
Sat	11:00	03:00	<u>Non standard timings. Where you intend to use the premises for the entertainment of a similar description to that falling within (e), (f) or (g) at different times to those listed in the column on the left, please list</u> (please read guidance note 5)		
Sun	11:00	02:00	An additional hour to the standard and non-standard times on the day when British Summertime commences New Years Eve – from the end of permitted hours on New Years Eve to the start of permitted hours on New Years Day One additional hour on the following dates: Christmas Eve, Boxing Day, St Georges Day, St Patricks Day, Valentines Day, Mothering Sunday & Fathers Day		

Provision of facilities for making music Standard days and timings (please read guidance note 6)			Please give a description of the facilities for making music you will be providing	
			Will the facilities for making music be indoors or outdoors or both – please tick (please read guidance note 2)	Indoors <input checked="" type="checkbox"/>
				Outdoors <input type="checkbox"/>
				Both <input type="checkbox"/>
Day	Start	Finish	Please give further details here (please read guidance note 3) From time to time the following facilities may be provided at the premises; in house sound/music system, musical instruments, video or tv screens	
Mon	11:00	02:00		
Tue	11:00	02:00		
Wed	11:00	02:00	State any seasonal variations for the provision of facilities for making music (please read guidance note 4)	
Thur	11:00	02:00		
Fri	11:00	03:00		
Sat	11:00	03:00	Non standard timings. Where you intend to use the premises for provision of facilities for making music at different times to those listed in the column on the left, please list (please read guidance note 5) An additional hour to the standard and non-standard times on the day when British Summertime commences	
Sun	11:00	02:00	New Years Eve – from the end of permitted hours on New Years Eve to the start of permitted hours on New Years Day One additional hour on the following dates: Christmas Eve, Boxing Day, St Georges Day, St Patricks Day, Valentines Day, Mothering Sunday & Fathers Day	

J

Provision of facilities for dancing Standard days and timings (please read guidance note 6)			Will the facilities for dancing be indoors or outdoors or both – please tick (see guidance note 2)	Indoors <input checked="" type="checkbox"/>
				Outdoors <input type="checkbox"/>
				Both <input type="checkbox"/>
Day	Start	Finish	Please give a description of the facilities for dancing you will be providing	
Mon	11:00	02:00	Please give further details here (please read guidance note 3) Provision of permanent or temporary dance floor	
Tue	11:00	02:00		
Wed	11:00	02:00	State any seasonal variations for providing dancing facilities (please read guidance note 4)	
Thur	11:00	02:00		
Fri	11:00	03:00	Non standard timings. Where you intend to use the premises for the provision of facilities for dancing at different times to those listed in the column on the left, please list (please read guidance note 5) An additional hour to the standard and non-standard times on the day when British Summertime commences New Years Eve – from the end of permitted hours on New Years Eve to the start of permitted hours on New Years Day One additional hour on the following dates: Christmas Eve, Boxing Day, St Georges Day, St Patricks Day, Valentines Day, Mothering Sunday & Fathers Day	
Sat	11:00	03:00		
Sun	11:00	02:00		

K

Provision of facilities for entertainment of a similar description to that falling within i or j Standard days and timings (please read guidance note 6)			<u>Please give a description of the type of entertainment facility you will be providing</u>		
Day	Start	Finish	<u>Will the entertainment facility be indoors or outdoors or both – please tick</u> (please read guidance note 2)	Indoors	<input checked="" type="checkbox"/>
Mon	11:00	02:00		Outdoors	<input type="checkbox"/>
				Both	<input type="checkbox"/>
Tue	11:00	02:00	<u>Please give further details here</u> (please read guidance note 3)		
Wed	11:00	02:00			
Thur	11:00	02:00			
Fri	11:00	03:00	<u>State any seasonal variations for the provision of facilities for entertainment of a similar description to that falling within i or j</u> (please read guidance note 4)		
Sat	11:00	03:00	<u>Non standard timings. Where you intend to use the premises for the provision of facilities for entertainment of a similar description to that falling within i or j at different times to those listed in the column on the left, please list</u> (please read guidance note 5) An additional hour to the standard and non-standard times on the day when British Summertime commences New Years Eve – from the end of permitted hours on New Years Eve to the start of permitted hours on New Years Day One additional hour on the following dates: Christmas Eve, Boxing Day, St Georges Day, St Patricks Day, Valentines Day, Mothering Sunday & Fathers Day		
Sun	11:00	02:00			

L

Late night refreshment Standard days and timings (please read guidance note 6)			Will the provision of late night refreshment take place indoors or outdoors or both – please tick (please read guidance note 2)	Indoors	<input checked="" type="checkbox"/>
Day	Start	Finish		Outdoors	<input type="checkbox"/>
				Both	<input type="checkbox"/>
Mon	23:00	02:00	Please give further details here (please read guidance note 3)		
Tue	23:00	02:00			
Wed	23:00	02:00	State any seasonal variations for the provision of late night refreshment (please read guidance note 4)		
Thur	23:00	02:00			
Fri	23:00	03:00	Non standard timings. Where you intend to use the premises for the provision of late night refreshment at different times, to those listed in the column on the left, please list (please read guidance note 5)		
Sat	23:00	03:00			
Sun	23:00	02:00	<p>An additional hour to the standard and non-standard times on the day when British Summertime commences</p> <p>New Years Eve – from the end of permitted hours on New Years Eve to the start of permitted hours on New Years Day.</p> <p>One additional hour on the following dates: Christmas Eve, Boxing Day, St Georges Day, St Patricks Day, Valentines Day, Mothering Sunday & Fathers Day</p>		

M

Supply of alcohol Standard days and timings (please read guidance note 6)			Will the supply of alcohol be for consumption (Please tick box) (please read guidance note 7)	On the premises	<input type="checkbox"/>
				Off the premises	<input type="checkbox"/>
				Both	<input checked="" type="checkbox"/>
Day	Start	Finish	State any seasonal variations for the supply of alcohol (please read guidance note 4)		
Mon	11:00	01:30			
Tue	11:00	01:30			
Wed	11:00	01:30	Non-standard timings. Where you intend to use the premises for the supply of alcohol at different times to those listed in the column on the left, please list (please read guidance note 5)		
Thur	11:00	01:30			
Fri	11:00	02:30			
Sat	11:00	02:30	An additional hour to the standard and non-standard times on the day when British Summertime commences		
Sun	11:00	01:30	New Years Eve – from the end of permitted hours on New Years Eve to the start of permitted hours on New Years Day.		
			One additional hour on the following dates: Christmas Eve, Boxing Day, St Georges Day, St Patricks Day, Valentines Day, Mothering Sunday & Fathers Day		

N

Please highlight any adult entertainment or services, activities, other entertainment or matters ancillary to the use of the premises that may give rise to concern in respect of children (please read guidance note 8)

None

O

Hours premises are open to the public Standard days and timings (please read guidance note 6)			State any seasonal variations (please read guidance note 4)		
Day	Start	Finish			
Mon	11:00	02:00			
Tue	11:00	02:00			
Wed	11:00	02:00	Non standard timings. Where you intend the premises to be open to the public at different times from those listed in the column on the left, please list (please read guidance note 5)		
Thur	11:00	02:00			
Fri	11:00	03:00			
Sat	11:00	03:00	An additional hour to the standard and non-standard times on the day when British Summertime commences		
Sun	11:00	02:00	New Years Eve – from the end of permitted hours on New Years Eve to the start of permitted hours on New Years Day.		
			One additional hour on the following dates: Christmas Eve, Boxing Day, St Georges Day, St Patricks Day, Valentines Day, Mothering Sunday & Fathers Day		

Please identify those conditions currently imposed on the licence which you believe could be removed as a consequence of the proposed variation you are seeking

To remove all conditions under Annex 2 and replace with those below

Please tick yes

- I have enclosed the premises licence
- I have enclosed the relevant part of the premises licence

If you have not ticked one of these boxes please fill in reasons for not including the licence, or part of it, below

Reasons why I have failed to enclose the premises licence or relevant part of premises licence
Licence will be hand delivered to your offices

P Describe any additional steps you intend to take to promote the four licensing objectives as a result of the proposed variation:

a) General – all four licensing objectives (b,c,d,e) (please read guidance note 9)

b) The prevention of crime and disorder

c) Public safety

d) The prevention of public nuisance

e) The protection of children from harm

Please tick yes

- I have made or enclosed payment of the fee
- I have sent copies of this application and the plan to responsible authorities and others where applicable
- I understand that I must now advertise my application
- I have enclosed the premises licence or relevant part of it or explanation
- I understand that if I do not comply with the above requirements my application will be rejected

b) Prevention of crime and disorder

1. All staff shall be trained in licensing law and this will include the law in relation to children and alcohol and the procedures that shall be adopted if it is considered that an individual may be under the age of 18. A record of the staff training will be maintained and can be inspected by the Police or Licensing Authority.
2. A proof of age scheme, such as Challenge 21, shall be operated at the premises where the only acceptable forms of identification will be recognised photographic identification cards, such as driving licence or passport.
3. Suitable beverages other than intoxicating liquor, including drinking water, shall be available at the premises.
4. The premises shall install and maintain a comprehensive CCTV system as per the minimum requirements of the Metropolitan Police Crime Prevention Officer. All entry and exit points will be covered, enabling frontal identification of every person entering in any light condition. The CCTV system shall continually record whilst the premises is open for licensable activities and during all times when customers remain on the premises. All recordings shall be stored for a minimum period of 31 days with date and time stamping. Records shall be made immediately available upon the request of police or authorised officers throughout the proceeding 31 day period.
5. A staff member from the premises who is conversant with the operation of the CCTV shall be on the premises at all times when the premises are open to the public. This staff member shall be able to show police recent data or footage with the absolute minimum of delay when requested.
6. The premises will operate a zero tolerance towards drugs.

c) Public safety

The premises will comply with all existing legislation in relation to fire safety, health and safety and food hygiene

d) The prevention of public nuisance

1. The premises licence holder shall use reasonable endeavours to ensure that no customer carrying open or sealed bottles shall be admitted to the premises (including any external seating area) at any time that the premises are open to the public.
2. The premises licence holder shall use reasonable endeavours to ensure that no persons shall be allowed to leave the licensed premises (including any external seating area) whilst in the possession of any drinking vessel or open glass bottle, whether empty or containing any beverage.
3. Prominent clear notices shall be displayed at all exits requesting that customers request the needs of local residents and leave the premises and area quietly.
4. When regulated entertainment (excluding films and plays) are provided all externally opening doors and windows must not be fixed open. In the event that the doors or windows are fixed open, the regulated entertainment must cease.
5. The premises licence holder shall ensure that the disposal of glass and bottles into outside bins does not take place between the hours of 23:00hrs and 07:00hrs.
6. The premises will risk assess the requirement for door supervisors.
7. Noise or vibration must not emanate from the premises so as to cause a nuisance to nearby properties.
8. Staff training will continue and include training in relation to accidents to staff and customers on

the premises and the requirement to deal with such problems.

9. The premises will operate a dispersal policy, a copy of which will be made available to the Police and Local Authority Licensing Officers as required.

e) The protection of children from harm

IT IS AN OFFENCE, LIABLE ON CONVICTION TO A FINE UP TO LEVEL 5 ON THE STANDARD SCALE, UNDER SECTION 158 OF THE LICENSING ACT 2003 TO MAKE A FALSE STATEMENT IN OR IN CONNECTION WITH THIS APPLICATION

Part 5 – Signatures (please read guidance note 10)

Signature of applicant (the current premises licence holder) or applicant’s solicitor or other duly authorised agent (please read guidance note 11). **If signing on behalf of the applicant please state in what capacity.**

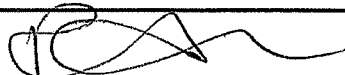
Signature	
Date	22 December 2010
Capacity	Poppleston Allen – Solicitors for & on behalf of the applicant

Where the premises licence is jointly held signature of 2nd applicant (the current premises licence holder) or 2nd applicant’s solicitor or other authorised agent (please read guidance note 12). **If signing on behalf of the applicant please state in what capacity.**

Signature	
Date	
Capacity	

Contact name (where not previously given) and address for correspondence associated with this application (please read guidance note 13)

Clare Eames
Poppleston Allen Solicitors
88 Kingsway

Post town	London	Post code	WC2B 6AA
Telephone number (if any)	0207 936 5875		
If you would prefer us to correspond with you by e-mail your e-mail address (optional) c.eames@popall.co.uk			

Notes for Guidance

This application cannot be used to vary the licence so as to extend the period for which the licence has effect or to vary substantially the premises to which it relates. If you wish to make that type of change to the premises licence you should make a new premises licence application under section 17 of the Licensing Act 2003.

1. Describe the premises. For example the type of premises, its general situation and layout and any other information which could be relevant to the licensing objectives. Where your application includes off-supplies of alcohol and you intend to provide a place for consumption of these off-supplies you must include a description of where the place will be and its proximity to the premises.
2. Where taking place in a building or other structure please tick as appropriate. Indoors may include a tent.
3. For example state type of activity to be authorised, if not already stated, and give relevant further details, for example (but not exclusively) whether or not music will be amplified or unamplified.
4. For example (but not exclusively), where the activity will occur on additional days during the summer months.
5. For example (but not exclusively), where you wish the activity to go on longer on a particular day e.g. Christmas Eve.
6. Please give timings in 24 hour clock (e.g. 16:00) and only give details for the days of the week when you intend the premises to be used for the activity.
7. If you wish people to be able to consume alcohol on the premises please tick on, if you wish people to be able to purchase alcohol to consume away from the premises please tick off. If you wish people to be able to do both please tick both.
8. Please give information about anything intended to occur at the premises or ancillary to the use of the premises which may give rise to concern in respect of children regardless of whether you intend children to have access to the premises, for example (but not exclusively) nudity or semi-nudity, films for restricted age groups, the presence of gaming machines.
9. Please list here steps you will take to promote all four licensing objectives together.
10. The application form must be signed.
11. An applicant's agent (for example solicitor) may sign the form on their behalf provided that they have actual authority to do so.
12. Where there is more than one applicant, both applicants or their respective agents must sign the application form.
13. This is the address which we shall use to correspond with you about this application.

I, **Michelle Peach** in the firm of Messrs. Poppleston Allen, Solicitors of 37 Stoney Street, The Lace Market, Nottingham, NG1 1LS refer to the following:-

1. Letter to London Borough of Haringey dated 22 November 2010
2. Application Form
3. Cheque in the sum of £315.00

I FURTHER CERTIFY that I have served documents 1 – 3 upon the following:-

1. Licensing, London Borough of Haringey, Environment, Techno Park, Ashley Road, Tottenham, London, N17 9LN

I FURTHER CERTIFY that I have served a true copy of documents 1 & 2 upon the following:-

2. , Metropolitan Police Service, Licensing, Quicksilver Patrol Base, Unit 1, Quicksilver Place, Western Road, Wood Green, London, N22 6UH
3. , London Fire & Emergency Planning Authority, Fire Safety Regulations - North East Area 2, London Fire Brigade, 169 Union Street, , SE1 0LL
4. Health & Safety , London Borough of Haringey, Enforcement Service, Technopark, Ashley Road, Tottenham, N17 9LN
5. Child Protection, Quicksilver Patrol Base, Unit 1, Quicksilver Place, Western Road, N22 6UH
6. Trading Standards , London Borough of Haringey, Enforcement Service, Ashley Road, Technopark, Tottenham, N17 9LN
7. Planning Enforcement , London Borough of Haringey, Environmental Services, 639 High Road, Tottenham, N17 8BD
8. Environmenal Health , London Borough of Haringey, Enforcement Service, Technopark, Ashley Road, Tottenham, N17 9LN

I effected service by sending the said documents to each and every one of them by special delivery addressed to them on 22 November 2010.

SIGNED

DATED: 22 November 2010

- LEGEND**
- UNIT OF LICENSED PREMISES
 - ☒ FIRE DETECTOR
 - ☒ SMOKE HALL SMOKE'S
 - ☒ SMOKE DETECTOR (SDDP20)
 - ☒ SAFETY LIGHT (SLS200)
 - ☒ FIRE ESCAPE KEYP CLEAR (SLS200)
 - ☒ FIRE ALARM CALL POINT (SLS200)
 - ☒ CARBON DIOXIDE FIRE EXTINGUISHER
 - ☒ 9 LIT. WATER FIRE EXTINGUISHER
 - ☒ 9 LIT. FOAM FIRE EXTINGUISHER
 - ☒ FIRE BLANKET
 - ☒ LOBBY STAIRS
 - ☒ W.C./PASSAGEWAY ETC
 - ☒ LIVE MUSIC

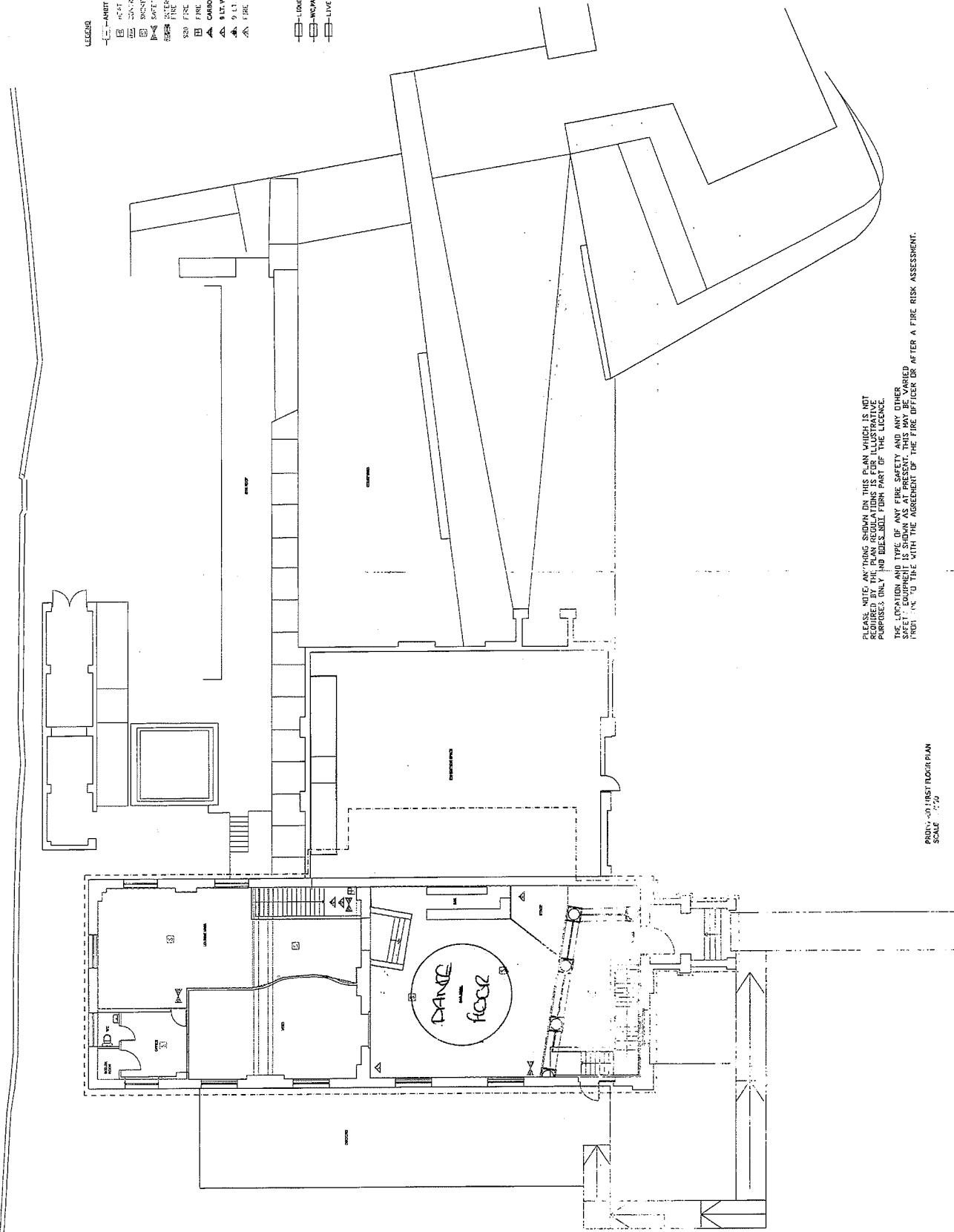

PLEASE NOTE ANYTHING SHOWN ON THIS PLAN WHICH IS NOT PROPOSED BY THE LICENSEE IS NOT PART OF THE LICENSE. THE LICENSEE AND THE FIRE SAFETY OFFICER SHALL BE RESPONSIBLE FOR THE SAFETY OF THE PREMISES. THIS PLAN IS SHOWN AS PRESENTLY EXISTING AND IS NOT TO BE TAKEN TO THE AGREEMENT OF THE FIRE OFFICER OR AFTER A FIRE RISK ASSESSMENT.

PB010-00 FIRST FLOOR PLAN
SCALE 1:750

PREMISES LICENCE

Receipt: F00109012120

Premises Licence Number: LN00002603
LN/000003158

This Premises Licence has been issued by:

**The Licensing Authority, London Borough of Haringey,
Urban Environment, Technopark, Ashley Road
Tottenham, London, N17 9LN**

Signature:

Date: 8th January 2008
19th July 2010

Part 1 – PREMISES DETAILS

Postal Address of Premises or, if none, Ordnance Survey map reference or description:

**KASSABA
1 NEW RIVER AVENUE
HORNSEY
LONDON
N8 7QD**

Where the Licence is time limited, the dates:

Not applicable

Licensable activities authorised by the Licence:

Supply of Alcohol

Provision of Late Night Refreshment

Regulated Entertainment: Live Music, Recorded Music

The times the Licence authorises the carrying out of licensable activities:

Supply of Alcohol

Monday to Saturday 1100 to 0100

Sunday 1200 to 2300

Provision of Late Night Refreshment

Monday to Saturday 2300 to 0130

Sunday 2300 to 2330

Live Music

Sunday to Thursday 1800 to 2300

Friday & Saturday 1800 to 0000

Recorded Music

Monday to Saturday 1100 to 0000

LICENSING ACT 2003
Sec 24

Sunday 1100 to 2300
New Years Eve 1100 to 0300
Christmas Eve, Boxing Day, St Georges Day, St Patrick's Day, Valentines Day
Mothering Sunday and Fathers Day 1100 to 0200

The opening hours of the premises:

Monday to Saturday 1100 to 0130
Sunday 1200 to 2330
New Years Eve 1100 to 0330
Christmas Eve, Boxing Day, St Georges Day, St Patrick's Day, Valentines Day
Mothering Sunday and Fathers Day 1100 to 0230

Where the Licence authorises supplies of alcohol whether these are on and/or off supplies:

Supply of alcohol for consumption **ON & OFF** the premises

Part 2

Name, (registered) address, telephone number and e-mail (where relevant) of holder of Premises Licence:

Roseflame Limited
Cambridge House
27 Cambridge Park
Wanstead
E11 2PU

Registered number of holder, for example company number, charity number (where applicable):

06796484

Name, address and telephone number of designated premises supervisor where the Premises Licence authorises the supply of alcohol:

Mr Asad Riaz
97 Edenbridge Road
Enfield
Middlesex
EN1 2HS

Personal Licence number and issuing authority of personal licence held by designated premises supervisor where the Premises Licence authorises for the supply of alcohol:

Personal Licence Number: LN/201000258
Expiry Date: 6th July 2020
Issued by: London Borough of Enfield

Annex 1 –Mandatory Conditions

Section 19

(1) No supply of alcohol may be made under the premises licence-

- (a) at a time when there is no designated premises supervisor in respect of the premises licence, or
- (b) at a time when the designated premises supervisor does not hold a personal licence or his personal licence is suspended.

(2) The second condition is that every supply of alcohol under the premises licence must be made or authorised by a person who holds a personal licence.

Additional Mandatory Conditions in relation to Supply of Alcohol

- 1.—(1) The responsible person shall take all reasonable steps to ensure that staff on relevant premises do not carry out, arrange or participate in any irresponsible promotions in relation to the premises.
 - (2) In this paragraph, an irresponsible promotion means any one or more of the following activities, or substantially similar activities, carried on for the purpose of encouraging the sale or supply of alcohol for consumption on the premises in a manner which carries a significant risk of leading or contributing to crime and disorder, prejudice to public safety, public nuisance, or harm to children—
 - (a) games or other activities which require or encourage, or are designed to require or encourage, individuals to—
 - (i) drink a quantity of alcohol within a time limit (other than to drink alcohol sold or supplied on the premises before the cessation of the period in which the responsible person is authorised to sell or supply alcohol), or
 - (ii) drink as much alcohol as possible (whether within a time limit or otherwise);
 - (b) provision of unlimited or unspecified quantities of alcohol free or for a fixed or discounted fee to the public or to a group defined by a particular characteristic (other than any promotion or discount available to an individual in respect of alcohol for consumption at a table meal, as defined in section 159 of the Act);
 - (c) provision of free or discounted alcohol or any other thing as a prize to encourage or reward the purchase and consumption of alcohol over a period of 24 hours or less;
 - (d) provision of free or discounted alcohol in relation to the viewing on the premises of a sporting event, where that provision is dependent on—
 - (i) the outcome of a race, competition or other event or process, or
 - (ii) the likelihood of anything occurring or not occurring;
 - (e) selling or supplying alcohol in association with promotional posters or flyers on, or in the vicinity of, the premises which can reasonably be considered to condone, encourage or glamorise anti-social behaviour or to refer to the effects of drunkenness in any favourable manner.
2. The responsible person shall ensure that no alcohol is dispensed directly by one person into the mouth of another (other than where that other person is unable to drink without assistance by reason of a disability).
3. The responsible person shall ensure that free tap water is provided on request to customers where it is reasonably available.

Annex 1 –Mandatory Conditions

- 4.—(1) The premises licence holder or club premises certificate holder shall ensure that an age verification policy applies to the premises in relation to the sale or supply of alcohol.
 - (2) The policy must require individuals who appear to the responsible person to be under 18 years of age (or such older age as may be specified in the policy) to produce on request, before being served alcohol, identification bearing their photograph, date of birth and a holographic mark.
5. The responsible person shall ensure that—
- (a) where any of the following alcoholic drinks is sold or supplied for consumption on the premises (other than alcoholic drinks sold or supplied having been made up in advance ready for sale or supply in a securely closed container) it is available to customers in the following measures—
 - (i) beer or cider: ½ pint;
 - (ii) gin, rum, vodka or whisky: 25 ml or 35 ml; and
 - (iii) still wine in a glass: 125 ml; and
 - (b) customers are made aware of the availability of these measures.

Annex 2 – Conditions consistent with the Operating Schedule

THE PREVENTION OF CRIME AND DISORDER

- Identification checks for people on the age.
- Warning signs relating to drugs.
- Frequent toilet checks by staff.
- Music to be monitored from the outside of the building to ensure it is not audible to cause a nuisance.
- Signs asking clientele to leave the premises quietly.

PUBLIC SAFETY

- Full CCTV installed with hard disk storage for police use.
- Emergency lighting and fire alarm installed.
- Fire fighting equipment is installed in the premises
- Advice to be taken from the fire authority with regards to the capacity of the venue.
- Full risk assessments to be carried out.

THE PREVENTION OF PUBLIC NUISANCE

- Key staff to be present at all trading hours.
- To liaise with any local residents association to ensure our clients do not cause any nuisance.
- After closing the area is checked for litter that may cause a nuisance.
- All deliveries and collections to take place at an hour not to cause concern to residents.

THE PROTECTION OF CHILDREN

- Challenge 21 scheme will be implemented.
- All refusal will be recorded from upstairs bar.
- Alcohol may only be sold to individuals over the age of 18 with valid proof of identification with one of the following:
 - A valid passport
 - A photo driving license issued in a European Union Country
 - A proof of age standard card system
 - A citizen card, supported by the Home Office
- If children are present accompanied by parents for dining we would like them off the premises by 1900
- All children under the age of 8 to be accompanied to the toilet by a parent or guardian.

Annex 3 – Conditions attached after a hearing by the licensing authority

Annex 4 – Plan of Premises

LODGED WITH LOCAL AUTHORITY